

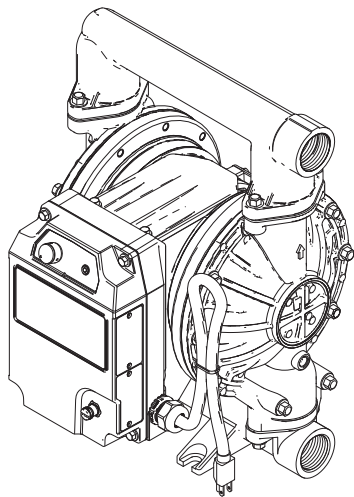

EODD IQUANTM - i80 | Atex, Aluminium & PTFE/Santoprene 2-piece.

The GRACO QUANTM™ electric operated double diaphragm pump combine all of the benefits of a traditional air operated diaphragm pump like self-priming, stalling under pressure and increased diaphragm life with the benefits of an electric pump like energy cost savings, reduced pulsation and increased pump control.

- Up to 80% more efficient than an air operated diaphragm pump
- Smart pump control for more accurate flow set points
- Integrated I/O for remote operation (I/O, 4-20mA)
- Reduce pulsation without the addition of pulsation dampeners
- Auto-priming (no need to fill the pump to operate)
- Can run dry
- Patent pending technology allows pump to stall under pressure (Dead-Head). Furthermore, preventing pump failures from clogged lines or closed valves
- Including Leak Sensor (auto-stop electric motor)
- IE5 (ultra premium) Efficiency Class Flux-core drive reduces energy consumption up to 8x compared to traditional air operated diaphragm pumps



Technical Specifications (Pump)

Material of Construction	Aluminum
Flow Rate (max./min.)	303 l/min. / 7,6 l/min.
Discharge Pressure (max.)	6,9 bar
Diaphragm	PTFE/Santoprene 2-piece
Ball Valve	PTFE
Valve Seat	Stainless Steel 316
Connection Size	1,5" (38,1 mm)
Fluid inlet/outlet	1,5" BSPT
Configuration	end-port
Max. suction lift*	wet: 8,8 ,m; Dry: 5,9 m
Max. solids	4,8 mm
Max fluid opr. temperature	82 °C
Amb. air temp. range of opr.	-20 °C to 40 °C
Leak Sensor Kit	Yes (included)
Hazardous Location (ATEX)	 ATEX II 2 G Ex db h IIB T4 Gb
Pump Weight	32,2 kg

* May vary based on pump materials, suction condition, discharge head, pressure, and fluid type.

Technical Specifications (Motor)

Type	Flux-Core drive
Voltage	200-240V, 50/60Hz
Current (max)	15A (230V)
IP Rating	IP66
Control	Local + Remote (I/O, 4-20mA)
Efficiency Class	IE5 - Ultra Premium
Cord/Cable Termination	Cable with flying leads

Performance Chart*

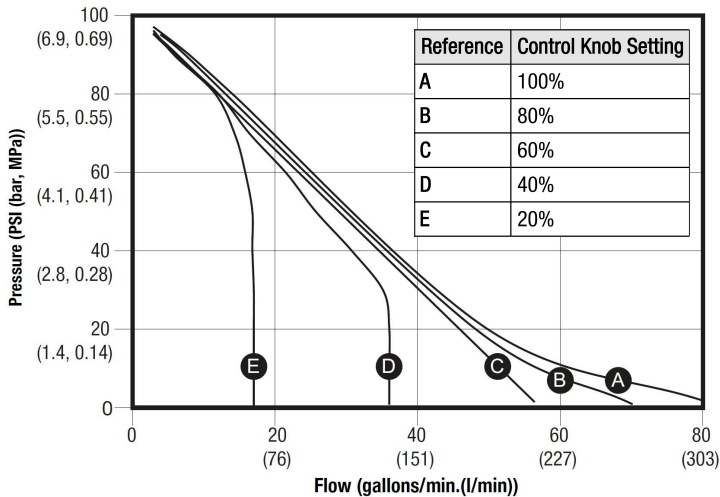

i80 - Performance

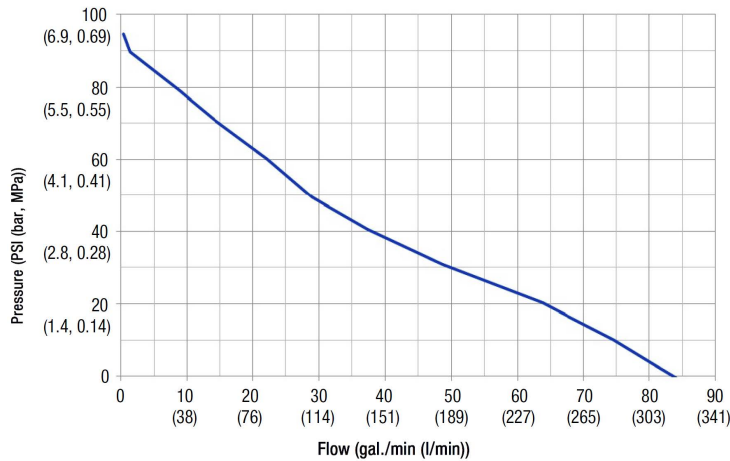

i80 - Power Curve

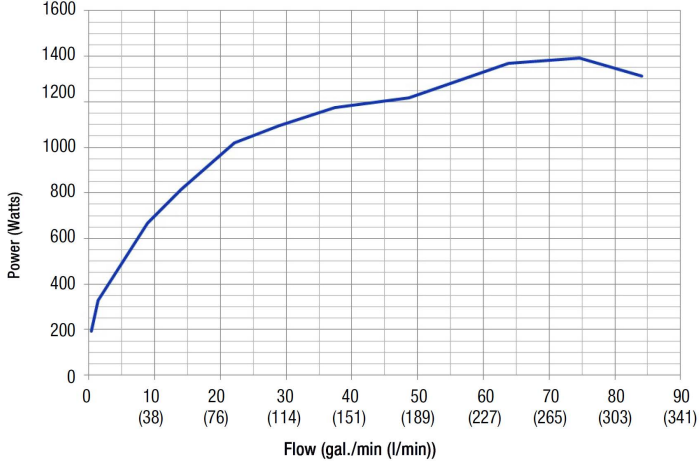

ALUMINUM PUMPS

DIM REF.	IN	CM
A	15.07	38.28
C	13.81	35.08
D	5.17	13.13
E	19.60	49.78
F	18.30	46.48
G	1.50	3.81
H	4.55	11.56
J	6.00	15.24
K	6.00	15.24

WEIGHT	
71 lb	32.2 kg

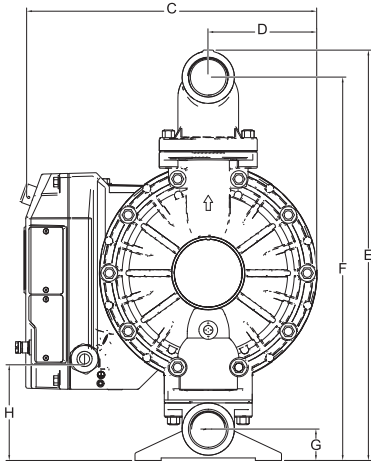

STAINLESS STEEL & HASTELLOY

DIM REF.	IN	CM
A	16.10	40.89
C	13.85	35.18
D	5.21	13.23
E	18.97	48.18
F	17.75	45.09
G	1.44	3.66
H	4.55	11.56
J	6.00	15.24
K	6.00	15.24

WEIGHT	
112 lb	50.8 kg

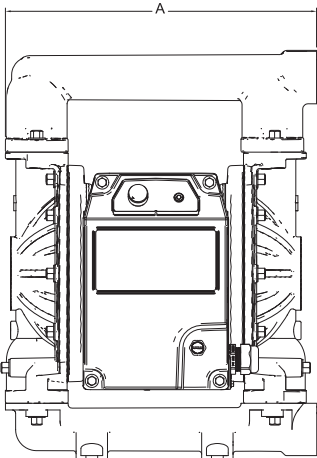

POLYPROPYLENE, CONDUCTIVE POLYPROPYLENE & PVDF

DIM REF.	IN	CM
A	17.60	44.70
C	13.87	35.23
D	5.23	13.28
E	22.00	55.88
F	19.30	49.02
G	3.00	7.62
H	5.85	14.86
J	6.00	15.24
K	6.00	15.24

WEIGHT	
PP, CP	75 lb 34 kg
PV	85 lb 38.5 kg

